

CV Driver MK2



Features

- DMX512 Controllable and RDM Configurable
- Designed for driving LED strips through 6 high power channels
- 12V and 24V DC output units available
- Easy addressing interface (physical switches and RDM)
- Isolated DMX input
- 6 x constant voltage controllable channel (Total 5A per output)
- 120 watts (73522) & 240 watts (73520) total output power
- Fused outputs with surge protection
- Power, status and output LED indicators
- Stand-alone output sequences (if configured, no external controllers required)
- Up to 8 units stackable using standard 19" modular rack accessory (sold separately)
- Ideal for white or RGB LED Tapes
- Standard IEC mains input connector
- Auto-selectable Multi voltage mains input

Safety

- Make all the connections before you plug in the main power
- Do not expose the ALEPH CV DRIVER to rain or moisture, doing this will void the warranty

- Do not spill water or other liquids into or onto the unit
- Check that the local power outlet matches that of the required voltage (110 → 240V AC)
- Do not remove the cover whilst the unit is powered
- Never plug this unit in to a dimmer pack
- Always be sure to mount this unit in an area that will allow proper ventilation. Allow about 6" (20 cm) between this device and a wall
- Make sure ventilation holes are clean and unobstructed
- Do not attempt to operate this unit, if it becomes damaged
- This unit is intended for indoor use only
- Always mount this unit in safe and stable manner
- Power-supply cords should be routed so that they are not likely to be walked on or pinched by items placed upon or against them, paying particular attention to the point they exit from the unit
- The driver should be situated away from heat sources
- Make sure the unit is dry and there is no fluids residue before powering the unit after cleaning

Physical Dimensions

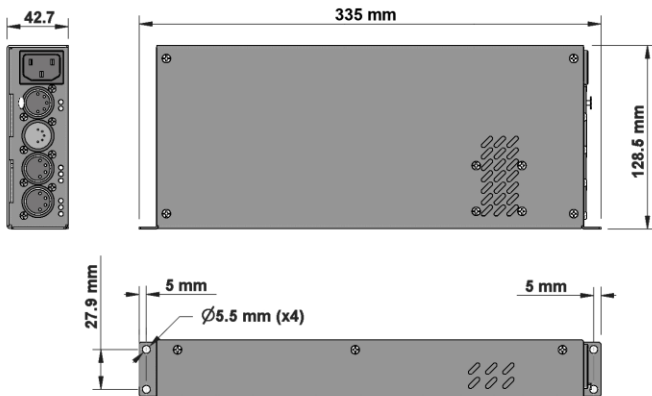

Ordering Information

PN	Description
73520	ALEPH CV DRIVER MK2 (24V)
73522	ALEPH CV DRIVER MK2 (12V)

Wiring Diagrams

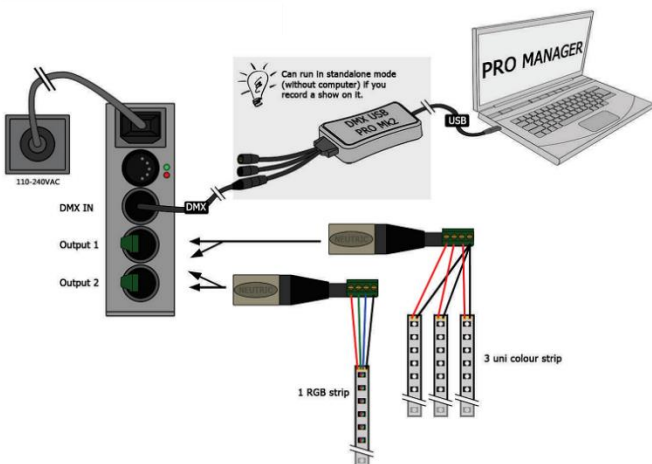

Accessories and Recommended Products

PN	Description
73526	XLR 4PIN TO SCREW TERMINAL OUTPUT CONVERTER
73530	A1 - 8 WAY CV RACK (240V AC)

Due to continuous improvements and innovations of all ENTTEC products, specifications and features are subject to change without notice.

Specifications

Item	Value
Input Voltage	110 – 240V AC
Input Frequency	50/60Hz
Max total Output Power	73520: 240 Watts 73522: 120 Watts
Max. Current Per output	5 Amps
Output Channels	6
Control Input	DMX512 & RDM E1.20
Personalities	3 DMX distributions: 6, 9 and 12 channels
Smart Dimming	14 bit internal dimming mapped to 8 bit S curve
Cooling Method	Forced air (temperature-regulated for low noise)
Ambient Working Temperature	5° to 35° C
Connectors	1x 5-Pin Male XLR for DMX input 1x 5-Pin Female XLR for DMX output 2x 4-Pin Female XLR for channels output 1x 3-Pin IEC C14 Male Socket 10Amps for mains
DMX Pinout	Pin1: Ground Pin2: Data – Pin3: Data +
Protection Rating	IP20
Net Weight	2.4 Kg
Shipping Weight	2.8 Kg

enttec.com

MELBOURNE AUS / LONDON UK / RALEIGH-DURHAM USA